



PRESENTED BY:

George Yineman, Commercial Realtor
701.223.2450 office

email: george@aspengrouprealestate.com
web: aspengrouprealestate.com

FOR SALE 218 South 26th Street



Land and Building Great Location in SE Bismarck

Price: \$695,000.00

Building Size: 9,520 SF

Lot Size: 56,109 SF (1.29 Acres)

Zoned: MA Light Industrial

Features: Highly Visible For Retail



701-223-2450 office
701-223-2322 fax
Bismarck, North Dakota

**Data Information Sheet
218 South 26th Street**

Building Size: 9,520 SF

Lot Size: 56,109 SF (1.29 acres)

Zoned: MA Light Industrial

Year Built: 1976, 1979, 1983

Taxes: \$7,222.97

Specials:: \$4,000.00 Balance, \$571.52 Installment

Utilities: \$356.00 Average Monthly

2006 Traffic Counts: 9,600 Cars per Day on 26th Street
10,900 Cars per Day on Main Avenue



REAL ESTATE SERVICES
Bismarck, North Dakota

**INFORMATION SHEET
SE Bismarck Land and Building**

- **7,154 SF Warehouse/Shop**
- **2,366 SF Office/Retail Area**
- **1,740 SF Mezzanine Storage Area Above Office**
- **Class “S” Pre-engineered Metal Building**
- **Concrete floor with VCT tile or carpet in office and retail areas**
- **1— 8 X 10 roll up overhead door on south side**
- **2— 12 X 16 roll up overhead doors on west side**
- **1—10 X 18 roll up overhead door on west side**
- **1—10 X 12 roll up overhead door on east side**
- **2— Walk-in doors in rear of building**
- **1—Glass storefront entrance**
- **2— Restrooms**
- **Floor drain in shop area**
- **Side wall height 22’**



REAL ESTATE SERVICES
Bismarck, North Dakota

- **2” Water Service Entrance**
- **200 AMP 3 Phase Electrical Service**
- **4—Reznor gas forced air space heaters**
- **2—Furnaces with central air conditioning and 2 air condensers on the roof**
- **Insulated roof in all warehouses**
- **New roof installed with additional insulation in 2001 as a result of hail damage**

Seller owns adjacent property. Consider both properties for the possible ownership of the entire corner.



REAL ESTATE SERVICES
Bismarck, North Dakota

Built: 1960
 Addn: 1976, 1979, 1983
 Type: 1 ST Metal
 Whse SF: 9520
 Total SF: 9520
 Perimeter: 474
 Height: 18.5' AV
 Mezz. Office: 841
 Mezz. Storage: 764
 Concrete: 3643

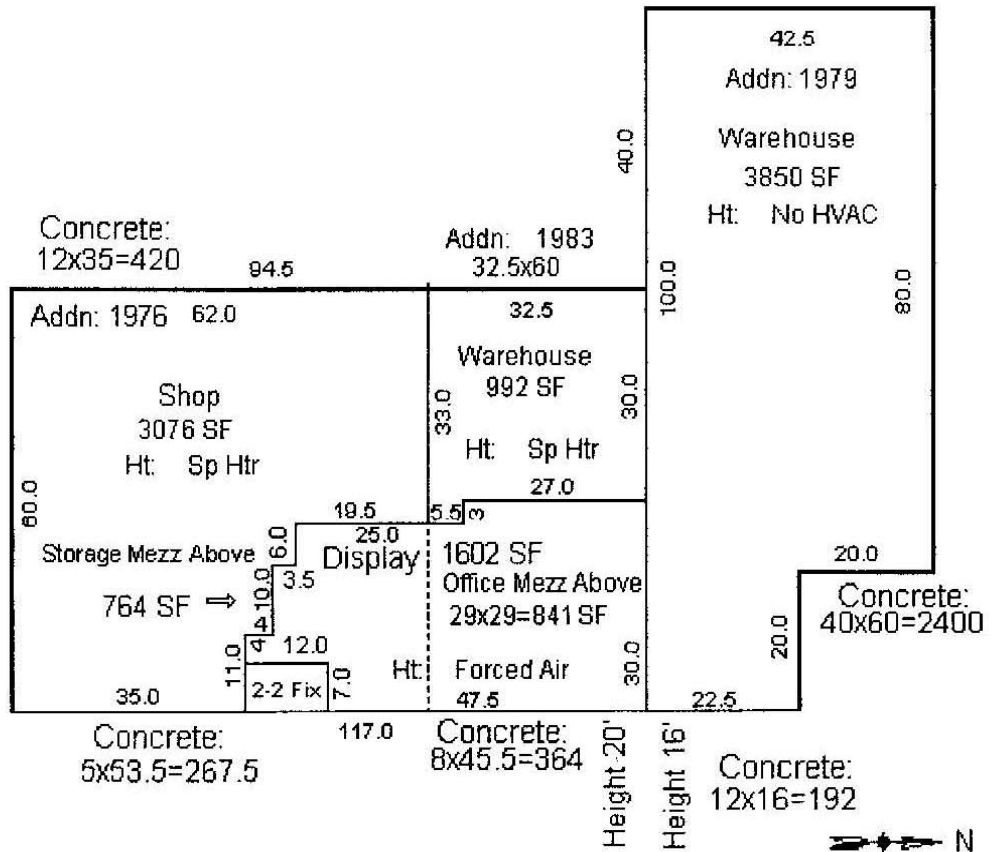

REAL ESTATE SERVICES
 Bismarck, North Dakota



REAL ESTATE SERVICES
Bismarck, North Dakota



REAL ESTATE SERVICES
Bismarck, North Dakota



REAL ESTATE SERVICES
Bismarck, North Dakota

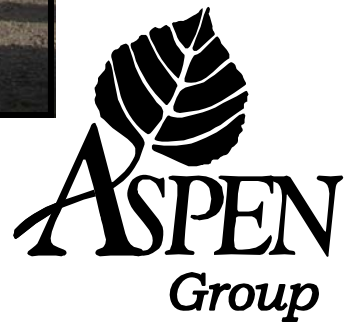

REAL ESTATE SERVICES
Bismarck, North Dakota



REAL ESTATE SERVICES
Bismarck, North Dakota



Main Street-Highway 10

Little Cottage Cafe

Big Boy

Railroad Avenue

Arrow Cleaning

Racer Performance

26th Street South

Subject Property